

NOTES
 This drawing to be read in conjunction with all relevant Architects and Engineers Drawings and Specifications
 Do not scale - use figured dimensions only
 Levels are given in metres and relate to Local Datum
 All dimensions are given in millimetres
 All dimensions to be checked on site

HERAS FENCING TO FACILITATE
 SCAFFOLDING ERECTION AND DISMANTLING
 TO REMAIN IN PLACE FROM
 27/02 - 15/03/2019
 AND FROM
 13/05 - 24/05/2019

HERAS FENCING COMPOUND
 FOR WORKS
 TO BE ERECTED 27/02/2019
 UNTIL 24/05/2019

PEDESTRIAN WALKWAY UNDER BRIDGE TO
 REOPEN ON COMPLETION OF ERECTION OF
 SCAFFOLDING AT CURTAIN WALL OF CASTLE
 CONTROLLED
 ACCESS POINT

CONTROLLED
 ACCESS POINT

KEY
 CONSERVATION WORKS
 SET-DOWN & LOADING AREA
 PEDESTRIAN ROUTE

- Legend
- | | | |
|---|--|--|
| <ul style="list-style-type: none"> □ AJ • Bol □ Bol • BS • CCTV □ CL — □ ER □ EP □ ESB □ FP □ Gas □ G □ Hyd □ IC □ LP □ LB □ MH | <ul style="list-style-type: none"> • MP □ PM • PB • RS 10.21 • SC • SV □ TE □ TP • TK □ TV • TL □ TR □ TD □ UL • V □ WM | <ul style="list-style-type: none"> Mooring Post Parking Meter Postbox Road Sign Spot Level Stop Cock Sluice Valve Telecom Cover Telecom Pole Telephone Box/Kiosk Television Cover Traffic Light Traffic Signal Cover Trap Door Tree Upight Valve Water Meter |
|---|--|--|

EXISTING WALKWAY ALONG SHANNON
 TO REMAIN OPEN
 ACCESS / EGRESS FOR DELIVERIES VIA THE ATHLONE
 FLOOD ALLEVIATION SCHEME COMPOUND

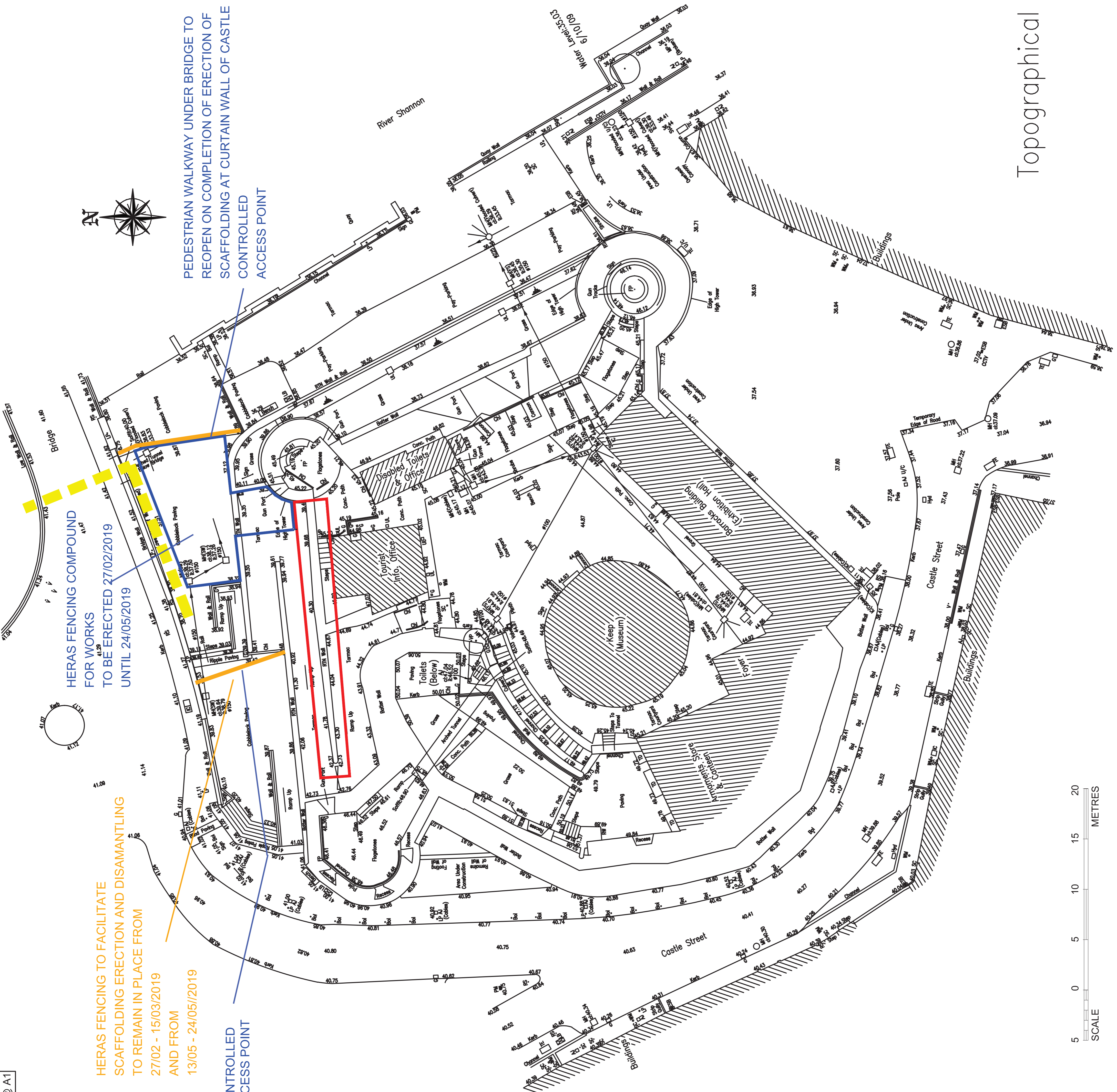

PROJECT Athlone Castle, Co. Westmeath	
DRAWING SITE LAYOUT PLAN	
National Monuments Service	Scale 1:200 @ A1
	Date 21.02.2019
	Drawn by J. O'Brien
	Surveyed by
	See Also Drg. No.
	Purpose Of Issue: HOARDING LAYOUT
	Drawing No.



Topographical Survey

